

2020 - 2021

Year Theme Verse:

*"Give thanks in all circumstances; for this
is the will of God in Christ Jesus for
you."
(1 Thessalonians 5:18)*



20 Seaborne Drive
Dover, NH 03820

603-742-3617

Lower School Absence Hotline ext. 112

www.pcaschool.org

Lower School Quick Reference Guide

This guide contains answers to the most commonly asked questions. Please refer to the Lower School Family Handbook located on Veracross for a comprehensive explanation of school policies and procedures.

Table of Contents

Mission Statement	4
Welcome to the 2020-2021 School Year	5
Frequently Asked Questions	6
What does the school day look like?	7
What are the Arrival/Dismissal Procedures?	7
Morning Arrival	7
Late/Tardy	8
Afternoon Dismissal	8
Traffic Patterns	8
Other Campus Rules	9
Additional Information for Parents	10
Kaleidoscope – Before and Aftercare	10
Kaleidoscope – After School Workshops	10
Kaleidoscope – Academic Enrichment & Support	10
Kaleidoscope – Private Music Lessons	10
Lunch Program	11
Volunteer Opportunities	11
Veracross	11
What happens when school is cancelled or my child can't come to school?	11
Severe Weather/School Cancellations	11
Sources of information on delays or cancellations	11
Virtual Day	12
Two-hour Delay Procedure and Schedule	12
What do I do if my child cannot attend school?	12
Dress Code	12
General Philosophy	12
20-21 Facial Covering/Mask Dress Code	13
Concept	13
Policy Enforcement	13
JH Men's Dress Code	14
JH Women's Dress Code	16
K-5 Boys' Dress Code	18
K-5 Girls' Dress Code	20
Scripture Memory 2020-2021	22
Key Dates 2020-21	24
School Supply List	25



Mission Statement

Portsmouth Christian Academy exists to honor God joyfully by inspiring students to maximize their God-given potential.

Welcome to the 2020-2021 School Year



Dear Lower School Families,

Welcome to the 2020-2021 school year at Portsmouth Christian Academy! I am so excited to welcome each of you to school in a few short weeks – the last few months have taught me not to take the opportunity of being together for granted! After emergency remote learning plus our summer vacation, we are preparing to welcome you back to campus. The efforts to do so safely have taken the hard work of many this summer, and we will continue to work diligently to maintain a safe, nurturing, and challenging learning environment for all our students.

I am eager to see your smiles, to hear the chatter in the classrooms, and to feel your contagious joy; our school building is just not the same when the halls and classrooms don't have you!

Please use this Quick Reference Guide to answer all your questions about procedures for the beginning of school, dress code, calendar events, and the monthly scripture verses for the entire school year. If you find yourself with unanswered questions, please call the Lower School Office or email me (cabood@pcaschool.org) or Mrs. Corso, Assistant Principal (dcorso@pcaschool.org). You will also find "Start of School" information on our website, www.pcaschool.org.

Because this year is unique with specific health and safety adjustments, there are a few important changes:

Arrival and Dismissal Procedures and Late Arrivals: pages 7-8

Facial Covering/Mask Dress Code: pages 12-13

Microwave Usage and Purchasing Snacks at the Lower School: pages 10-11

Before/AfterCare and Kaleidoscope: pages 7, 10

This school year, our Bible theme verse is 1 Thessalonians 5:18:

"Give thanks in all circumstances; for this is the will of God in Christ Jesus for you."

As a community of believers, it is imperative that we continue to find and recognize the blessings of our Lord, even during times of trial and difficulty. When we seek to magnify what is good and praiseworthy in our lives, we will continue to uncover more and more thanksgivings. Throughout the year, I encourage each of you to think about and discuss as a family our theme verse, 1 Thessalonians 5:18.

Again, welcome to a new school year, and may the Lord bless you and keep you,

Carrie

Carrie Abood, Ed.D.
Lower School Principal
cabood@pcaschool.org

Frequently Asked Questions

When do Teacher Welcome Letters arrive?

Teacher welcome letters should arrive sometime after the second week of August.

Why does Veracross have to be shut down?

In order to place students in new classes, we have to shut down the portal.

Is the school open during the weeks of August?

Yes, we are here at least Tuesday through Thursday 9 am-1 pm.

What if I have dress code questions?

Daphne Corso will be happy to answer your questions; please email her at, dcorso@pcaschool.org, or leave her a voicemail at extension 127.

Where can I find the Lower School Family Handbook?

The Handbook can be found on Veracross within the Parent Portal.



What does the school day look like?

7:15	Before Care Opens
7:45	Arrival begins
8:15	K-8 Opening Exercises (in classrooms, virtual)
8:20	Start of Academics: See Student Schedules from Teachers (considered Tardy for arrival after 8:20 AM)
3:00	K-5 Dismissal
3:20	6-8 Dismissal
3:20	K-5 Dismissal Ends (Remaining students to Aftercare or Kaleidoscope) K-8 Bus Students Dismissed
3:30	PCA Bus Departs 6-8 Dismissal Ends (Remaining students to Aftercare of Kaleidoscope)
5:45	Aftercare Closes



What are the Arrival/Dismissal Procedures?

Morning Arrival

Health Prescreening Arrival Procedures:

Note: As the health situation evolves, our arrival procedures are subject to change. Any changes will be clearly communicated to parents and students in advance.

To ensure the health and safety of our community, every student and employee at PCA must complete a Pre-screening Health Check form each morning before coming onto campus. Families will be able to download the SNAP Health Portal app and complete the Pre-screening Health Check. To ensure we have your information for a smooth arrival, please complete the screening **by 7:00am**.

Students arriving by car:

Arrival begins at 7:45am. Only pre-registered BeforeCare students will be allowed to enter the building before 7:45am. Families who arrive before 7:45 and are not registered for BeforeCare will queue in the Lower School parking lot (this queue will be in the same location for dismissal).

To expedite the health screening confirmation during arrival, **each family will use their assigned carpool number (PCAP-Grade 12)**. Please have your carpool number displayed in the car windshield (passenger's side). This is how we will identify your family. Completed and confirmed screenings will be cleared to continue to the Lower School Upper Loop for drop-off. Students will exit their cars and enter the designated House Entrances. If the health screening is not complete, you will be asked to park in the designated parking spots and complete the form before returning to the arrival line.

Students arriving by bus:

Bus drivers will ensure that all bus passengers have completed the Pre-screen Health Check before getting onto the bus.

*All students (K-8th grade) should arrive in time to begin class at 8:20, but students are preferred to arrive by 8:15 for virtual Opening Exercises.

Late/Tardy

Students in Grades K-8 are marked tardy if they arrive after 8:20. Late-arriving families will be directed to the Lower School parking lot. Parents will need to park and walk students to the main entrance, where a PCA staff member will confirm health screening and direct students in entering their designated House Entrances. The receptionist will issue a tardy slip. The check-in process for late arrivals will take more time than an on-time arrival; we encourage families to arrive on-time!

Afternoon Dismissal

Dismissal numbers for students in K – 5 will be called beginning at 3:00 and ending at 3:20. Students in K – 5 who have not been dismissed by 3:20 will be released to Aftercare (families must pre-register for Aftercare each quarter). Aftercare will remain within each House (Primary, Elementary, and Junior High).

Students in K – 5 will be dismissed from the upper loop and exit the building from their designated House doors.

Dismissal numbers for students in Junior High (Grades 6-8) will be called beginning at 3:20 and ending at 3:30. Any Junior High students who have not been picked up by 3:30 will be released to Aftercare at 3:30 (families must pre-register for Aftercare each quarter). Aftercare will remain within each House (Primary, Elementary, and Junior High).

If you are picking up students from both K – 5 and JH, please pick up your K-5 student and then proceed to the lower loop for your Junior High student so that the Upper Loop does not get blocked for other parents.

If a student needs to be dismissed early, please do so by 2:30. This allows time for the Receptionist and Lower School Office to prepare for normal dismissal routines. **The Main lobby will close to parents at 2:45pm to clear the area for a safe and healthy dismissal; all parents will need to pick-up students through the dismissal line process.**

Traffic Patterns

We ask that drivers adhere to the traffic flow diagram below to ensure the safety of all children. Automobiles parked in the restricted areas pose a safety threat. The following diagram indicates the traffic pattern to follow:

- A. Driveway for buses, morning drop-off, upper loop student dismissal (K-5)
- B. Parking entrance for staff, visitors and driveway for lower loop student dismissal (JH)
- C. Staff and Visitor Parking
- D. Exit for staff, visitors, and lower loop student dismissal
- E. Handicap Parking area
- F. During upper loop Arrival and Dismissal, move forward to gym doors.

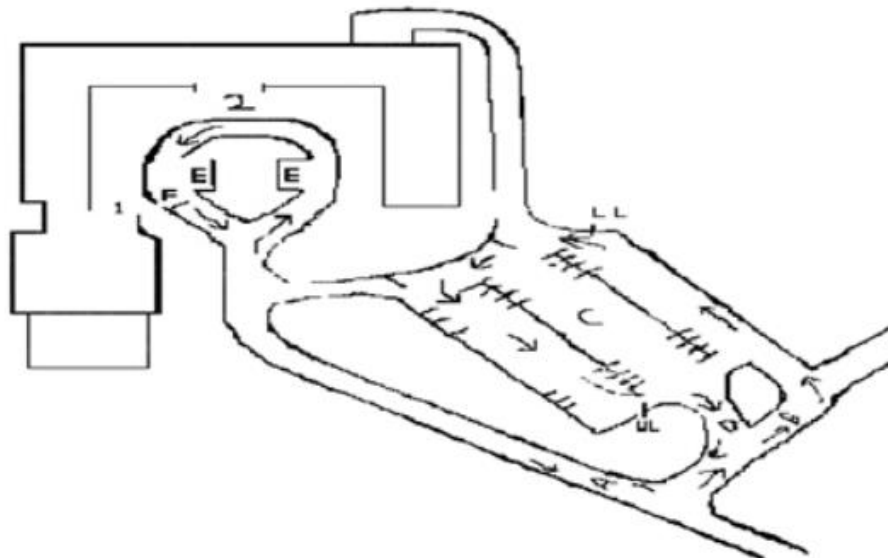

Other Campus Rules

- **Your carpool number must be displayed in the car windshield (passenger's side) during dismissal** (available during Open House or sent to you via your youngest child's teacher).
- **Please enter upper loop only after having given the carpool number** to the caller (at the top of the hill). *Through car pool numbers, teachers will be notified that you are arriving and will send the student out to the loading area.*
- **Cars should park in the parking lot.**
- **Please move as far forward** as possible and we will bring your child(ren) to you. This allows us to safely place several students in cars at the same time, thus reducing wait time.
- **Please do not attempt to pass cars on Seaborne**, unless directed by staff. Passing on this road unexpectedly places two cars going in opposite directions in the same lane and endangers people.
- **Call the school office if a non-parent/guardian will pick up your child.** K-5 students will not, for any reason, be dismissed to drivers who do not have the correct dismissal number. When a driver without the correct number requests to dismiss a student, the driver will be asked to park in the parking lot and wait for the school to contact a parent of the child. The wait for contact to be made may be lengthy or unproductive.
- **Parking should be in designated areas only.** We have been blessed with a beautiful campus so, in order to maintain its beauty, we ask that no one parks on grassy areas.
- **Avoid opening or propping doors.** To ensure safety, all students and adults are to use the monitored entrances of the school. No one should open a perimeter door or prop the door for entry in any other area.
- **Late-arriving families will be directed to the Lower School parking lot.** Parents will need to park and walk students to the main entrance, where a PCA staff member will confirm health screening and direct students in entering their designated House Entrances. The receptionist will issue a tardy slip. The check-in process for late arrivals will take more time than an on-time arrival; we encourage families to arrive on-time!
- **All guests and visitors are to enter through the main entrance, sign in with the receptionist and obtain/wear a "Visitor" tag for the duration of their visit**, so that adults in the building recognize safety procedures have been followed. Please sign out and return the Visitor pass when departing. This allows the accounting for all people in an emergency.
- **When passing through halls, please move quietly in order to not disturb learning.**
- **Children should use age-appropriate playgrounds** (preschoolers use preschool playground; K-5 use elementary playground; JH students use fields)
- **Parents are asked not to go to classrooms at arrival and dismissal.** Because these are periods when transitions must be monitored carefully, the teacher needs to place full attention on his or her students.

When an early dismissal is necessary, parents may ask the Receptionist to call for students to meet at their designated House door, send in an early dismissal note to the teacher or call the office. Early dismissals need to occur by 2:30pm.

Additional Information for Parents

Kaleidoscope – Before and Aftercare

Before care (7:15-7:45) takes place within each house (PCAP, Primary, Elementary, and Junior High). Students are to be dropped off at the designated House doors.

Aftercare (3:30-5:45) takes place within each house (PCAP, Primary, Elementary, and Junior High). Students enjoy recess outside when the weather is favorable and do homework, play games, and socialize in each house space. Parents will pick-up students in Aftercare from the designated House doors after communicating your arrival with the Aftercare staff. Parents will remain outside the building during pick-up. Please bring your driver's license and carpool number with you, as you may be asked to show it, for the safety of our students. Sign your child out from Aftercare with our staff.

NEW REGISTRATION and BILLING Information: Families interested in Beforecare and Aftercare services will need to pre-register each quarter through the Kaleidoscope registration page. Pre-registration will allow PCA to staff each house appropriately for the number of students registered.

Pre-registration prices and options:

Beforecare

7:15-7:45 = \$3.50/day per student

Aftercare

3:30-4:30 = \$7/day per student

3:30-5:45 = \$14/day per student

While we anticipate providing *emergency* support for families in Beforecare and Aftercare, we will not be able to offer drop-in service. Please make plans to register for Beforecare and Aftercare at the beginning of each quarter. There is a surcharge for non-registered/emergency care and for anyone picked up *after* 5:45pm. The surcharge is \$10.00 for the first 10 minutes and then \$1.00 for every minute thereafter. Additionally, more than 3 late pick-ups (After 5:45pm) in a year could result in the loss of Aftercare options.

Please email Mrs. Karnes at jkarnes@pcaschool.org for any questions related to Beforecare and Aftercare.

Kaleidoscope – After School Workshops

Families have the option to enroll students in a small group class that teaches skills outside of the traditional academic curriculum. Some of our favorite offerings include taekwon do, robotics, pottery, origami, tennis, basketball, dodgeball, music groups, and so many more! Most classes meet for 30 minutes once a week for the entire length of the quarter. However, there are many other options that extend past school, as alternatives to the aftercare program. When classes are over, students are escorted to where they await your arrival for afterschool pick-up.

Kaleidoscope – Academic Enrichment & Support

Kaleidoscope Enrichment Programs offer a variety of solutions to help provide additional challenge or academic support. Whether the need is 1-on-1 tutoring in a subject, or some help developing organizational and time-management skills, our staff is willing and able to lend the help that he/she needs. Private tutoring is available at a rate of \$35.00 per hour. If your child exhibits more critical needs, we also offer occupational therapy and speech therapy to help him/her thrive here in our community. We partner with Dynamic Learning Solutions, a local not for profit organization that employs highly qualified individuals who are trained to meet the diverse needs of our student body from preschool through high school.

Kaleidoscope – Private Music Lessons

Our staff of highly qualified music teachers offer private lessons throughout the school year on campus at Portsmouth Christian Academy. Students may take lessons during free periods, lunch and recess periods, or before and after school depending on your schedule. Please contact our Kaleidoscope Coordinator for rates.

Lunch Program

PCA has arranged with several local restaurants to provide lunches to our students which parents may purchase on a quarterly basis throughout the school year. This provides an alternative to packing a lunch each day for your child.

Microwave Use and Purchasing Snacks: We ask parents to send lunch and snack options that do not need heating, **as microwaves will not be accessible within Lower School Houses at this time in the school year.** Families are encouraged to use a Thermos to keep food warm until lunchtime. Additionally, snacks will not be available for purchase through the Lower School Office.

Volunteer Opportunities

There are many opportunities for each family to be connected within the PCA community through the Volunteer Service Program. Whether you choose to chaperone field trips, help in the library, deliver lunches, decorate or bake for special events, serve with our maintenance crew, or utilize your skills in another way, you will undoubtedly find a way to be involved in your child's education. The Volunteer Service Program will be sending out a survey through email for you to fill out before the start of school. Our Volunteer Coordinator, Jodi Karnes, uses the information provided to match your interests, gifts, and availability with our current volunteer opportunities. Please be advised, a background check and Code of Ethics Form, must be completed prior to volunteering. For more information regarding our Volunteer Service Program, please contact Jodi Karnes at jkarnes@pcaschool.org.

Veracross

All PCA families have a Veracross account. This is our school database that allows parents access to their children's assignments, grades and attendance records. In addition, parents can sign up and pay for programs such as lunch and Kaleidoscope classes. Veracross also provides access to the family directory and PCA's event calendar.

Instructions and passwords for accessing Veracross through the web are emailed to new families. Returning families can learn more about Veracross at <http://www.veracross.com>. A quick link to the Veracross login can be found on PCA's website in the upper right hand corner.

What happens when school is cancelled or my child can't come to school?

Severe Weather/School Cancellations

We know that any change to routine is disruptive and try to minimize cancellations and late openings. However, PCA is somewhat unique in that our student body is drawn from forty different communities located in three states and many arrive in privately owned vehicles.

After listening to local radio and television stations, consulting people in the affected areas and, in some cases, calling the State Police and Public Works personnel, the Head of School will make a decision that is believed to be in the best interest of the majority of the school population. When the decision to cancel school is made, the announcement is posted on PCA's website (www.pcaschool.org), is broadcasted over regional radio stations, and appears on local television stations. This broadcast is rarely later than 6:00 AM. We recommend that you tune in on days when a delay or closing is anticipated. In addition, a phone alert goes to the provided numbers of all students, faculty and staff members.

While, in making our decision regarding cancellation, we consider both major and secondary roads in our entire catchment area, each parent is encouraged to decide for himself or herself if the trip from home to school is safe.

Sources of information on delays or cancellations

WMUR TV NH channel 9

WCSH TV ME channel 6

WBZ TVMA MA channel 4

Website www.pcaschool.org

Virtual Day

When the forecast indicates a strong probability for the need to cancel school, students will be assigned virtual work through Office 365 Teams and Veracross. This virtual work is designed to help the student continue learning while at home **if** school is cancelled; therefore this assigned work is NOT optional and will be considered incomplete until turned in.

Activities may include the following:

- Reading and responding to content material
- Reinforcement of math skills to improve mastery
- Science projects, particularly relating to the storm
- Writing assignments
- Make-up work

The amount of time spent on these assignments should not exceed three hours and, while parents may assist, the work is intended to be done with a relative degree of independence.

Two-hour Delay Procedure and Schedule

Whenever appropriate, PCA will announce a two-hour delay on days when the weather is questionable. This choice gives us time to evaluate the severity of the storm, and it also gives the public transportation department the time to clear and salt the roads, allowing for a safer commute.

Buses will run on a two-hour delay; please be at the Bus Stop early.

Schedule for 2-hour delay

The PCA bus will run on a two-hour delay.

9:15	Before Care Opens
9:45	Arrival Begins
10:15	K-8 Opening Exercises (in classrooms, virtual)
10:20	K-8 Classes Begin

What do I do if my child cannot attend school?

When your child cannot attend school, please let us know via the PCA Lower School Absence Hotline at 603-742-3617, ext.112. You may be prompted to give symptoms in order for us to fulfill our commitment to the NH Department of Health in tracking flu symptoms.

For long-term absences, see *Lower School Family Handbook* on Veracross under 'Parent' portal.

Dress Code

General Philosophy

We believe that a student's individuality is more properly expressed by what he or she does and believes than by what is worn. In short, the heart of the child is far more important than how one chooses to adorn one's body. Neatness, good grooming and modest fashions are appropriate in a school that encourages students to focus attention on more meaningful matters than the latest fashions. The purpose of this dress code is to offer the students several options of comfortable, attractive and reasonably priced clothing that will reflect well on the students and the school. We do not want extremes, and we do not want students testing the limits of the policy. The key to the dress code is the fit and style of the clothing. Variations from the required style are not acceptable. Our suggestion is to err on the side of conservative dress, hairstyle and clothing accessories. When in doubt, please ask the dress code question before the item in question is worn to school.

20-21 Facial Covering/Mask Dress Code

Students in Grades K-12 will be required to wear a cloth or disposable facial covering/mask at *certain* times during the school day (when entering/exiting the building, moving in the hallways, and when 6 ft. distancing cannot be maintained within the classroom). Parents are asked to provide masks for their students. If a student forgets his/her mask, the school will provide a disposable one.

Please follow these guidelines when purchasing or making cloth facial coverings/masks for your student(s):

- An approved facial covering/mask covers both the nose and mouth — face shields are not approved substitutes.
- We recommend each student own 3-5 masks, with one mask kept in a backpack or locker as a back-up if needed.
- PCA is not requiring a specific color, style, pattern, or brand.
- Masks that could be a distraction to learning are prohibited — this includes slogans, overtly-distracting styles, political statements, anything violent, or prints that do not align with PCA's mission, statement of faith, or Core Values.

Concept

This dress code policy contains information concerning the acceptable styles, colors and combinations of clothing for males and females. Students are free to choose from several options contained on the clothing chart unless it is a "dress up" day (e.g., chapel, graduation, award ceremonies) or "casual" day (e.g., Spirit Week, certain field trips).

Dress code charts may also be accessed on PCA's website.

Policy Enforcement

The faculty and principals are the sole arbiters of the dress code policy. When students in grades kindergarten through eighth are determined to be in violation of the dress code, an email notification will be made home to inform the parent(s)/guardian(s) of the infraction. When three email notifications have been made, any future infractions will require the parent to bring to school the proper dress code item(s). The student will remain out of class until determined to be in compliance with the dress code or until a satisfactory plan for compliance is in place. Continued noncompliance may result in more significant action. Suggestions or questions concerning the policy should be brought to the attention of the Assistant Principal.

It is impossible for a dress code to address each possible piece of clothing or adornment. The following is provided in an attempt to clarify what is acceptable dress code attire.

Portsmouth Christian Academy Dress Code

Where do I buy dress code clothing?

Land's End (www.landsend.com/pp/SchoolSearch.html?action=landing&selectedSchoolNum=900027376) and JCPenney's (www.jcp.com) are the **only** approved school uniform vendors for PCA. Items may **not** be purchased elsewhere, with the exception of some PE clothing.

When going to the Land's End site, enter PCA's Preferred School Number, 900027376. Then enter your child's age and gender, no other identifying personal information is necessary.

"Boy's" or "Men's" sizes are acceptable.

"Girl's" or "Women's" sizes are acceptable.

When going to the JCP site, select "kids" or "juniors" sizing, "School Uniform" tab (**JCP is typically used only for alternative sizing and they do not do the PCA monogrammed logos**).

JH Men's Dress Code

It is impossible for a dress code to address each possible piece of clothing or adornment. The following is provided in an attempt to provide information regarding some of the more common areas of concern.

Category	Details	Colors	Notes
Everyday Tops	Standard fit polo (short or long sleeve; Interlock or mesh)	White, Grey, Burgundy, Black, Green, Yellow, Red, Light Blue, Navy, Cobalt	Land's End login must be used to access PCA approved styles. Must have a PCA-approved logo. Shirts must be tucked into bottoms. Short-sleeved shirts may <u>not</u> be worn over long-sleeved shirts.
Everyday Bottoms	Chino pants Shorts (<2" above knee)	Khaki or Navy	Land's End login must be used to access PCA approved styles. Belt must be worn if item has belt loops.
Chapel Tops	Standard collar shirt Button-down shirt Short or long-sleeve	White	Land's End login must be used to access PCA approved styles. Ties are required to be worn on chapel days. Ties may be removed for recess only.
Chapel Bottoms	Chino pants	Navy or Khaki	Land's End login must be used to access PCA approved styles. Belt is to be worn if item has loops. Shorts are <u>not</u> allowed on Chapel days.
PE Tops	Crew neck t-shirt, Performance or Essential Short or long sleeve Crew-collared sweatshirt	White, Grey, Burgundy	Land's End login must be used to access PCA approved styles. Must have PCA-approved logo. Solid color PCA team t-shirts and PCA Spirit Wear in these colors are also acceptable.
PE Bottoms	Athletic shorts (<2" above knee) Sweat pants Track Pants (from Land's End only)	Black, Grey, Burgundy	Solid color and loose-fitting No stripes
Shoes	Closed-toed shoes Athletic		One pair of non-marking athletic shoes must be left at school for P.E.

Category	Details	Colors	Notes
Additional Layers	V-neck sweater Cardigan sweater (zip or button) Vest ½-Zip fleece jacket Fleece jacket	White, Burgundy, Navy, Green, Yellow, Black	<i>Land's End</i> login must be used to access PCA approved styles. May have a PCA-approved logo but must be purchased through Land's End. Must be worn over approved collared shirt.
Accessories et. al.	Belts Ties Hair Tattoos Piercing Jewelry Outerwear Hats	Solid color Solid burgundy	Belts will be in good repair with the belt tip neatly tucked into the belt retainer. Large buckles are not permitted. Ties may be worn at any time that a dress shirt is being worn in accordance with the dress code. Ties should be worn snug against the shirt collar and will be belt length. No string or bow ties are permitted. Male students will wear hair neatly combed, in traditional men's style and of natural color. Hair length will not exceed the collar and neither tails nor pony tails are permitted. Gelling, spiking, or chiseling hair to make it look tiered or unusual is not permitted. Tattoos are not permitted. All students are discouraged from piercing any part of their body. Piercing jewelry may not be worn in school. Unless otherwise instructed, outer garments are to be removed upon entering the school and placed on an assigned coat hook or in a locker. Hooded sweatshirts and fleece (not specified above) are considered outerwear. All hats, kerchiefs and head coverings will be removed upon entering the school building.

JH Women's Dress Code

It is impossible for a dress code to address each possible piece of clothing or adornment. The following is provided in an attempt to provide information regarding some of the more common areas of concern.

Category	Details	Colors	Notes
Everyday Tops	Standard fit polo Feminine-fit polo Short or long sleeve Interlock or mesh	White, Grey, Burgundy, Black, Green, Yellow, Red, Pink Light Blue, Navy, Cobalt,	<i>Land's End</i> login must be used to access PCA approved styles. Must have a PCA-approved logo. Shirts must be tucked into bottoms. Short-sleeved shirts may not be worn over long-sleeved shirts.
Everyday Bottoms	Chino pants Shorts (<2" above knee) Skirts/skorts (to the knee) Pencil cut pants (<i>Land's End</i> only)	Khaki or Navy	<i>Land's End</i> login must be used to access PCA approved styles. Belt must be worn if item has belt loops. Chapel bottoms are also acceptable. Several hem lengths are available to accommodate body styles, but please remember skirts/skorts must be to the knee in actual fit.
Chapel Tops	Button-down oxford Short or long-sleeve	White	<i>Land's End</i> login must be used to access PCA approved styles. Blouses may be worn untucked. Undergarments (e.g., camis) may not be visible.
Chapel Bottoms	Skirt (to the knee)	Navy or Khaki	<i>Land's End</i> login must be used to access PCA approved styles. Several hem lengths are available to accommodate body styles, but please remember skirts must be to the knee in actual fit.
PE Tops	Crew neck t-shirt, Performance or Essential Short or long sleeve Crew-collared sweatshirt	White, Grey, Burgundy	<i>Land's End</i> login must be used to access PCA approved styles. Must have PCA-approved logo. Solid color, no hoodies PCA team t-shirts and PCA Spirit Wear in these colors are also acceptable (but no hoodies).
PE Bottoms	Athletic shorts (past fingertip length) Sweat pants Track Pants (from <i>Land's End</i> only)	Black, Grey, Burgundy	Athletic shorts may be purchased in solid black, grey, or burgundy from another source if they meet the "past fingertip" length. Solid color and loose-fitting, no stripes

Category	Details	Colors	Notes
Shoes	Shoe Sandal Boot Athletic		<2" Heel on all shoes One pair of non-marking athletic shoes must be left at school for P.E.
Additional Layers	V-neck sweater Cardigan sweater (zip or button) Vest ½-Zip fleece jacket Fleece jacket	White, Burgundy, Navy, Green, Yellow, Black	<i>Land's End</i> login must be used to access PCA approved styles. May have a PCA-approved logo. Must be worn over approved collared shirt.
Accessories et. al.	Tights, Socks, or Leggings (worn with skirts or shorts) Belts Hair Tattoos Piercing Jewelry Outerwear Hats	Solid neutral color	Belts will be in good repair with the belt tip neatly tucked into the belt retainer. Large buckles are not permitted. Hair will be neatly worn and of natural color. Gelling, spiking or chiseling hair to make it look tiered or unusual is not permitted. Tattoos are not permitted. All students are discouraged from piercing any part of their body. However, pierced ears are permitted, wearing up to two earrings in each ear lobe. Female students may wear earrings, necklaces, bracelets, and watches as long as they are worn in a tasteful manner as determined by the teacher and/or Assistant Principal. Unless otherwise instructed, outer garments are to be removed upon entering the school and placed on an assigned coat hook or in a locker. Hooded sweatshirts and fleece (not specified above) are considered outerwear. All hats, kerchiefs and head coverings will be removed upon entering the school building and will remain off until departure.

K-5 Boys' Dress Code

It is impossible for a dress code to address each possible piece of clothing or adornment. The following is provided in an attempt to provide information regarding some of the more common areas of concern.

Category	Details	Colors	Notes
Everyday Tops	Standard fit polo Short or long-sleeve Interlock or mesh	White or Burgundy	<i>Land's End</i> login must be used to access PCA approved styles. Must have a PCA-approved logo. Shirts must be tucked into bottoms. Short-sleeved shirts may not be worn over long-sleeved shirts.
Everyday Bottoms	Chino pants, flat front or pleated Shorts, flat or pleated (<2" above knee)	Khaki	<i>Land's End</i> login must be used to access PCA approved styles. In grades 3-5, belt must be worn if the item has belt loops.
Chapel Tops	Standard collar Button-down Short or long-sleeve	White or Light Blue	<i>Land's End</i> login must be used to access PCA approved styles. Ties are required to be worn on chapel days. Ties may be removed for recess only.
Chapel Bottoms	Chino pants or shorts, flat front or pleated	Khaki	<i>Land's End</i> login must be used to access PCA approved styles. In grades 3-5, belt must be worn if the item has belt loops.
PE Tops	Crew neck t-shirt, Performance or Essential Short or long sleeve Crew-collared sweatshirt	White, Grey, Burgundy	<i>Land's End</i> login must be used to access PCA approved styles. Must have a PCA-approved logo. Solid color PCA team t-shirts and PCA Spirit Wear in these colors are also acceptable.
PE Bottoms	Athletic shorts (<2" above knee) Sweat pants Track Pants (from <i>Land's End</i> only)	Black, Grey, Burgundy	Solid color, loose-fitting No stripes
Shoes	Closed-toe shoes Athletic		One pair of non-marking athletic shoes must be left at school for P.E.

Category	Details	Colors	Notes
Additional Layers (for in-school wear)	V-neck sweater Cardigan sweater (zip or button) Vest ½-Zip fleece jacket Fleece jacket	White or Burgundy	<i>Land's End</i> login must be used to access PCA approved styles. May have a PCA-approved logo. Must be worn over an approved, collared shirt.
Accessories	Belts Ties Hair Tattoos Piercing Jewellery Outwear Hats	Solid color Solid Burgundy	Belts will be in good repair with the belt tip neatly tucked into the belt retainer. Ties may be worn at any time that a dress shirt is being worn in accordance with the dress code. Ties should be worn snug against the shirt collar and will be belt length. No string or bow ties are permitted. Male students will wear their hair neatly combed, in traditional men's style and of natural color. Male students' hair length will not exceed the collar and neither tails nor pony tails are permitted. Gelling, spiking or chiseling hair to make it look tiered or unusual is not permitted. Tattoos are not permitted. All students are discouraged from piercing any part of their body. Unless otherwise instructed, outer garments are to be removed upon entering the school and placed on an assigned coat hook or in a locker. Hooded sweatshirts are considered outerwear. All hats, scarves, kerchiefs and other head coverings will be removed upon entering the school building and will remain off until departure. Hats worn on the playground will be in good taste and worn as designed (e.g. visor forward).

K-5 Girls' Dress Code

It is impossible for a dress code to address each possible piece of clothing or adornment. The following is provided in an attempt to provide information regarding some of the more common areas of concern.

Category	Details	Colors	Notes
Everyday Tops	Standard fit polo Feminine-fit polo Short or long sleeve Interlock or mesh	White or Burgundy	<i>Land's End login must be used to access PCA approved styles.</i> Must have a PCA-approved logo. Shirts must be tucked into bottoms. Short-sleeved shirts may <u>not</u> be worn over long-sleeved shirts.
Everyday Bottoms	Chino pants Shorts (<2" above knee) Pencil cut pants (Land's End only) Skirts/skorts (to the knee) Jumpers (to the knee)	Khaki	<i>Land's End login must be used to access PCA approved styles.</i> Belt must be worn if item has belt loops in grades 3-5. Several hem lengths are available to accommodate body styles, but please remember skirts/skorts must be to the knee in actual length. Jumpers must be worn over an approved dress code top.
Chapel Tops	Knit "Peter Pan" collar polo Oxford Shirt Short or long-sleeve	White or Light Blue	<i>Land's End login must be used to access PCA approved styles.</i> Ruffled collar is also acceptable.
Chapel Bottoms	Skirt (to the knee length) Jumpers (to the knee length)	Khaki	<i>Land's End login must be used to access PCA approved styles.</i> Several hem lengths are available to accommodate body styles, but please remember skirts must be to the knee in actual length.
PE Tops	Crew neck t-shirt, Performance or Essential Short or long sleeve Crew-collared sweatshirt	White, Grey, Burgundy	<i>Land's End login must be used to access PCA approved styles.</i> Must have PCA-approved logo. Solid color PCA team t-shirts and PCA Spirit Wear in these colors are also acceptable.
PE Bottoms	Athletic shorts (<2" above knee) Sweat pants Track Pants (from Land's End only)	Black, Grey, Burgundy	Females will need to use Boy's or Men's sizing for shorts in order to meet the length requirement and may purchase solid black, grey, or burgundy girls athletic shorts from another source if they meet the <2" above the knee rule. Solid color and loose-fitting, no stripes

Category	Details	Colors	Notes
Shoes	<p><2" heel, closed-toed</p> <p>Sandals with ankle strap</p> <p>Athletic</p> <p>Boots</p>		<p>No flip-flops</p> <p>Clean, non-marking soled sneakers are to be left at school.</p> <p>Snow boots are not to be worn in the classroom.</p>
Additional Layers (for in-school wear)	<p>V-neck sweater</p> <p>Cardigan sweater (zip or button)</p> <p>Vest</p> <p>½-Zip fleece jacket</p> <p>Fleece jacket</p>	White or Burgundy	<p><i>Land's End</i> login must be used to access PCA approved styles.</p> <p>May have a PCA-approved logo.</p> <p>Must be worn over approved collared shirt.</p>
Accessories etc.	<p>Tights, Socks, or Leggings (worn with skirts or shorts)</p> <p>Belts</p> <p>Hair</p> <p>Tattoos</p> <p>Piercing</p> <p>Jewelry</p> <p>Outerwear</p> <p>Hats</p>	<p>Solid neutral color</p> <p>Solid color</p>	<p>Belts will be in good repair with the belt tip neatly tucked into the belt retainer.</p> <p>Belts are optional for K-2 students.</p> <p>Hair will be neatly worn and of natural color. Gelling, spiking or chiseling hair to make it look tiered or unusual is not permitted.</p> <p>Tattoos are not permitted.</p> <p>All students are discouraged from piercing any part of their body. However, pierced ears are permitted, for females wearing up to two earrings in each ear lobe.</p> <p>Female students may wear earrings, necklaces, bracelets and watches as long as they are worn in a tasteful manner as determined by the teacher and/or Asst. Principal.</p> <p>Unless otherwise instructed, outer garments are to be removed upon entering the school and placed on an assigned coat hook or in a locker. Hooded sweatshirts are considered outerwear.</p> <p>All hats, scarves, kerchiefs and head coverings will be removed upon entering the school building and will remain off until departure. Hats worn on the playground will be in good taste and worn as designed.</p>

Scripture Memory 2020-2021

Annual Theme

Curiosity: Awe, wonder, and exploration of God's Word and His world

Theme Verse

I Thessalonians 5:18: Give thanks in all circumstances; for this is the will of God in Christ Jesus for you.

MONTH	VIRTUE	REFERENCE	SCRIPTURE	HONOR SCRIPTURE
September	Faith	John 3:16-18 1 John 4:7-8	For God so loved the world, that he gave his only Son, that whoever believes in him should not perish but have eternal life. For God did not send his Son into the world to condemn the world, but in order that the world might be saved through him. Whoever believes in him is not condemned, but whoever does not believe is condemned already, because he has not believed in the name of the only Son of God. John 3:16-18	Beloved, let us love one another, for love is from God, and whoever loves has been born of God and knows God. Anyone who does not love does not know God, because God is love. 1 John 4:7-8
October	Joyfulness	Philippians 4:4-7 Psalm 37:4	Rejoice in the Lord always; again I will say, rejoice. Let your reasonableness be known to everyone. The Lord is at hand; do not be anxious about anything, but in everything by prayer and supplication with thanksgiving let your requests be made known to God. And the peace of God, which surpasses all understanding, will guard your hearts and your minds in Christ Jesus. Philippians 4:4-7	Delight yourself in the Lord, and he will give you the desires of your heart. Psalm 37:4
November	Curiosity	Psalms 100 Psalm 66:1-2	Make a joyful noise to the Lord, all the earth! Serve the Lord with gladness! Come into his presence with singing! Know that the Lord, he is God! It is he who made us, and we are his; we are his people, and the sheep of his pasture. Enter his gates with thanksgiving, and his courts with praise! Give thanks to him; bless his name! For the Lord is good; his steadfast love endures forever, and his faithfulness to all generations. Psalm 100	Give thanks in all circumstances; for this is the will of God in Christ Jesus for you. I Thessalonians 5:18
December	Wonder	Luke 2:8-12 Luke 2:13-14	And in the same region there were shepherds out in the field, keeping watch over their flock by night. And an angel of the Lord appeared to them, and the glory of the Lord shone around them, and they were filled with great fear. And the angel said to them, "Fear not, for behold, I bring you	And suddenly there was with the angel a multitude of the heavenly host praising God and saying, "Glory to God in the highest, and on

			<i>good news of great joy that will be for all the people. For unto you is born this day in the city of David a Savior, who is Christ the Lord. And this will be a sign for you: you will find a baby wrapped in swaddling cloths and lying in a manger.”</i> <i>Luke 2:8-12</i>	<i>earth peace among those with whom he is pleased!”</i> <i>Luke 2:13-14</i>
<i>January</i>	<i>Excellence</i>	<i>Colossians 3:14-17</i> <i>Proverbs 3:5-6</i>	<i>And above all these put on love, which binds everything together in perfect harmony. And let the peace of Christ rule in your hearts, to which indeed you were called in one body. And be thankful. Let the word of Christ dwell in you richly, teaching and admonishing one another in all wisdom, singing psalms and hymns and spiritual songs, with thankfulness in your hearts to God. And whatever you do, in word or deed, do everything in the name of the Lord Jesus, giving thanks to God the Father through him.</i> <i>Colossians 3:14-17</i>	<i>Trust in the Lord with all your heart, and do not lean on your own understanding. In all your ways acknowledge him, and he will make straight your paths.</i> <i>Proverbs 3:5-6</i>
<i>February</i>	<i>Integrity</i>	<i>1 John 3:23-24</i> <i>John 13:34</i>	<i>And this is his commandment, that we believe in the name of his Son Jesus Christ and love one another, just as he has commanded us. Whoever keeps his commandments abides in God and God in him. And by this we know that he abides in us, by the Spirit whom he has given us.</i> <i>1 John 3:23-24</i>	<i>A new commandment I give to you, that you love one another: just as I have loved you, you also are to love one another.</i> <i>John 13:34</i>
<i>March</i>	<i>Caring</i>	<i>Matthew 5:3-9</i> <i>Matthew 5:10-12a</i>	<i>Blessed are the poor in spirit, for theirs is the kingdom of heaven. Blessed are those who mourn, for they shall be comforted. Blessed are the meek, for they shall inherit the earth. Blessed are those who hunger and thirst for righteousness, for they shall be satisfied. Blessed are the merciful, for they shall receive mercy. Blessed are the pure in heart, for they shall see God. Blessed are the peacemakers, for they shall be called sons of God.</i> <i>Matthew 5:3-9</i>	<i>Blessed are those who are persecuted for righteousness' sake, for theirs is the kingdom of heaven. Blessed are you when others revile you and persecute you and utter all kinds of evil against you falsely on my account. Rejoice and be glad, for your reward is great in heaven,</i> <i>Matthew 5:10-12a</i>
<i>April</i>	<i>Forgiveness</i>	<i>Luke 24:1-6a</i> <i>Luke 24:6b-7</i>	<i>But on the first day of the week, at early dawn, they went to the tomb, taking the spices they had prepared. And they found the stone rolled away from the tomb, but when they went in they did not</i>	<i>“Remember how he told you, while he was still in Galilee, that the Son of Man must be delivered into the hands of sinful</i>

			<p><i>find the body of the Lord Jesus. While they were perplexed about this, behold, two men stood by them in dazzling apparel. And as they were frightened and bowed their faces to the ground, the men said to them, "Why do you seek the living among the dead? He is not here, but has risen."</i></p> <p><i>Luke 24:1-6a</i></p>	<p><i>men and be crucified and on the third day rise."</i></p> <p><i>Luke 24:6b-7</i></p>
May	Love	<p><i>1 Corinthians 13:4-8</i></p> <p><i>1 Corinthians 13:11-13</i></p>	<p><i>Love is patient and kind; love does not envy or boast; it is not arrogant or rude. It does not insist on its own way; it is not irritable or resentful; it does not rejoice at wrongdoing, but rejoices with the truth. Love bears all things, believes all things, hopes all things, endures all things. Love never ends. As for prophecies, they will pass away; as for tongues, they will cease; as for knowledge, it will pass away.</i></p> <p><i>1 Corinthians 13:4-8</i></p>	<p><i>When I was a child, I spoke like a child, I thought like a child, I reasoned like a child. When I became a man, I gave up childish ways. For now we see in a mirror dimly, but then face to face. Now I know in part; then I shall know fully, even as I have been fully known. So now faith, hope, and love abide, these three; but the greatest of these is love.</i></p> <p><i>1 Corinthians 13:11-13</i></p>

Key Dates 2020-21

Early Release Days

Fri, 10/30	End of Qtr. 1
Tue, 11/3	Election Day
Tues, 11/10	P/T Conferences
Thurs, 11/12	P/T Conferences
Fri, 1/22	End of Qtr. 2
Sat, 3/20	Auction
Thurs, 3/25	End of Qtr. 3
Fri, 4/2	Good Friday
Tues, 6/9	Last Day of School

No School Days

Mon, 9/7	Labor Day
Mon, 10/12	Columbus Day
Fri, 11/20	Teacher In-service
Wed, 11/25-Fri, 11/27	Thanksgiving
Mon, 1/18	Martin Luther King Day
Fri, 3/26	Teacher In-Service
Mon, 5/31	Memorial Day

School Supply List

Portsmouth Christian Academy at Dover

2020-2021 SUPPLY LISTS

The following lists have been created to help make your Back-to-School shopping a bit easier! If your child's teacher would like to have anything else for the classroom, the teacher will let you know in the welcome letter. Many families find that the Open House is a good time to bring these supplies to school.

Art

- 2 #2 Pencils
- 2 Glue sticks
- 2 Black Sharpie pens (fine or extra fine tipped)
- 1 22"x28" Poster board (grades K-5 only)
- 9 x 12 Sketchbook (grades 3-8 only, may use previous sketchbook)

Computer (grades 3 – 8)

- One set of headphones in a Ziploc bag, labeled with child's name, to be left in the computer lab during the school year (new students and grade 3 only, returning student can use last year's)

Physical Education (all grades):

- Non-marking sneakers (to be left at school). Primary level students should use sneakers they are able to put on independently (i.e. Velcro)
- Sweat pants as described on PCA's website
- T-shirt with PCA logo as described on PCA's website
- Shorts (allowed throughout the year) as described on PCA's website
- Sweatshirt with PCA logo as described on PCA's website

Science (grades 6 – 8):

- (1) 1" 3 ring binder
- 3 dividers for binder
- Loose leaf paper for binder
- 1 package of index cards
- 2 rolls of paper towels or disinfecting wipes
- Please turn in the index cards, wipes, and paper towels to the science room.

Spanish and Mandarin:

Grade K-4

- 1 Box of crayons
- 1 Glue stick

Grade 5-6

- Plastic folder with pockets, 3 prongs
- Package of pencils

Grade 7-8

- 1½" 3-ring binder
- Dividers for 3-ring binder

Music (grades 4 - 8)

Concert Attire (grades 4 – 5): Students are expected to dress up (dresses/ties/dress shoes/etc.) and may wear something Christmassy (Dec) or Springy (Apr). Suit coats are optional. Simply wearing chapel attire is acceptable.

Concert Attire (grades 6 – 8): Please wear white on top (chapel shirt or modest dressy blouse) and dress pants or long skirts on the bottom (black preferred, but any chapel attire is acceptable). Gentlemen should wear a tie. Suit coats are optional. Footwear should be nice-looking and non-distracting.

Band (grades 4-8):

- Instrument and case in working condition (rental options available)
- Woodwinds: reeds and cork grease.
- Brass: valve oil and slide grease.
- Percussion: drumstick, drum pad, and bell kit
- A microphone (built-in or external) connected to their computer / iPad. This will be used with a school-provided Smart Music account online.
- Music stand for home practice (can use piano stand).
- A pack of sharpened pencils with eraser
- Music book: available on rental day through Music and Arts (www.musicarts.com), in music stores, or online.

4th and 5th Grade Bands: *Tradition of Excellence Book I* for your child's instrument

Junior High Band: *Tradition of Excellence Book II* for your child's instrument.

Chorus (grades 4-8):

- Sharpened pencil with eraser

- 1 Large box of tissues

Orchestra (grades 4-8):

- Instrument, bow and case, all in working condition and correctly sized for student (rental options available)
- Basic supplies for all: rosin, soft flannel cloth, an extra set of strings and a music stand for home practice (can use piano stand).
- Violins & violas: shoulder rest – correct size
- Cellos: endpin anchor strap or “donut”
- Sharpened pencil with eraser
- Music book: available on rental day through Music and Arts (www.musicarts.com), in music stores, or online.

4th and 5th grade orchestra: *Essential Elements for Strings Book 1* for your child’s instrument
Junior High: *Essential Elements for Strings Book 2* for your child’s instrument.

Music Exploration (grades 6-8): Ukulele

- A music fee of \$100 covers the purchase of a ukulele & case (\$75), tuner (\$10), and book (\$15). If you already own your own ukulele and case, the fee will be \$25.
- A folder
- Sharpened pencil and eraser

Kindergarten

- backpack, the size that can easily hold a folder and lunchbox
- 1 large pencil case
- 12 yellow Ticonderoga #2 pencils, sharpened
- 1 Crayola water color paint set
- 6 white glue sticks
- 1 box 8 count primary colored Crayola crayons (for classroom centers)
- 24 count Crayola crayons (additional, for student desks)
- 1 hardcover primary composition book with space for pictures at the top of the page
- 1 pair child's Fiskar scissors
- 1 set of primary color washable markers
- 2 cans Playdoh
- 2 plastic pocket folders
- 1 Pink pearl erasers
- 3 containers unscented baby wipes
- 2 boxes of tissues
- 2 rolls of paper towels
- 1 small bottle hand sanitizer
- Box of plastic spoons

- Box of plastic drinking straws
- Small whiteboard (about 9”x12”)
- Pack of whiteboard markers
- Pack of white or colored cardstock
- 3 Loose leaf 1” rings (easy opening)

First grade

- ESV Bible
- backpack
- 1 large cloth pencil case
- 12 yellow Ticonderoga #2 pencils, sharpened
- 4 glue sticks
- 2 boxes (16-24 count) Crayola crayons
- 1 box colored pencils
- 1 hardcover primary composition book with space for pictures at the top of the page
- 1 pair child's blunt Fiskar scissors
- 1 set of primary color washable markers
- 3 folders
- 1 ruler with centimeters and inches
- 1 child-sized headphones
- 2 large boxes of tissues
- 1 roll of paper towels
- 3 packages baby wipes
- 1 bottle hand sanitizer
- 1 standard size clipboard

Wish List:

Skinny Whiteboard Markers, Clorox wipes, plastic spoons

Second Grade

- ESV Bible
- backpack
- 1 pencil case that fits into desk
- 36 yellow Ticonderoga #2 pencils, sharpened
- 1 Crayola water color paint set
- 9 glue sticks
- 1 bottle of white school glue
- 2, 24 count Crayola crayons
- 1 hardcover composition books
- 1 pair child's blunt Fiskar scissors
- 1 box of washable markers
- (2) plastic 2-pocket folders prongs (yellow and blue)
- (1) plastic 2-pocket folders (red)
- 1 sturdy plastic 2-pocket folder with 3 prongs (for homework)
- 1 pink pearl eraser
- 1 ruler with centimeters and inches
- 1 red pen
- 1 yellow highlighter
- 1 small white board

- 2 white board markers
- 1 package 50 clear page protectors
- 1 ½" **WHITE** 3 ring binder
- 1 pencil sharpener with enclosure
- 5 containers unscented baby wipes
- 1 large box of tissues
- 1 roll of paper towels
- 1 bottle hand sanitizer
- 1 child-sized headphones

Third Grade

- ESV Bible
- backpack
- 1 pencil case that fits into desk
- 24 yellow Ticonderoga #2 pencils, sharpened
- 4 glue sticks
- 1 box colored pencils
- 4 hardcover composition books
- 1 pair scissors w/ point
- 2 boxes markers (1 fine tip and 1 regular)
- 1 plastic 2-pocket folder (purple)
- 1 plastic 2-pocket folder (green)
- 1 plastic 2-pocket folder (yellow)
- 1 sturdy plastic pocket folder (red)
- 2 pink pearl erasers
- (1) 12" ruler with centimeters and inches
- 4 highlighters, 1 of which is yellow
- 1 small white board
- 1 package skinny white board markers
- (1) 1-inch 3 ring binder
- 1 package sticky notes
- 1 hand held pencil sharpener w/ enclosure
- 1 bottle hand sanitizer
- 5 containers unscented baby wipes
- 2 large boxes of tissues
- 2-3 rolls of paper towels If your last name begins with A-M – please bring in these supplies in August. If your last name begins with N-Z please bring in January when we come back from Christmas vacation.

Fourth Grade

- ESV Bible
- backpack
- 1 (8" x 5" or smaller) pencil case
- 48 yellow Ticonderoga #2 pencils, sharpened
- 6 glue sticks
- 1 box (24-count) colored pencils
- 1 hardcover composition book
- 1 pair scissors w/ points

- 1 box markers
- (1) green pocket folder
- (1) blue pocket folder
- (1) pocket folder (red) with for homework
- 2 colored pens
- 2-4 highlighters (all different colors)
- 1 thick dry erase marker for classroom
- 1 clipboard
- (1) 2" 3-ring binder
- (1) ½" 3-ring binder
- 1 package college ruled notebook paper
- 2 packs of 8 binder dividers **with pockets**
- 2 thin black sharpies (NOT sharpie pens)
- 2 packages pencil cap erasers
- 1 box plastic spoons/forks
- 1 container unscented baby wipes
- 1 large box of tissues
- 1 bottle hand sanitizer
- 1 box spoons or forks
- 3 rolls of paper towels

Math

- 1 composition book
- (1) 12" ruler with centimeters and inches
- 1 plastic protractor with degrees listed both ways
- 1 small white board (approx. 12" x 9") and eraser
- 4 personal white board markers

Fifth Grade

- ESV Bible
- Backpack
- 3" 3-ring binder
- 1 large pencil case
- 24 yellow Ticonderoga #2 pencils, sharpened
- 4 glue sticks
- colored pencils / markers / crayons
- 4 hardcover composition books
- 1 pair scissors w/ point
- 2 book covers
- 1 blue and 1 black pen (total 2)
- 4 highlighters (4 colors)
- 2 package sticky notes (3x3)
- 1 packages college ruled notebook paper
- 1 pack of 8 plastic binder dividers with tabs
- 1 hand held pencil sharpener w/ enclosure
- 2 package pencil cap erasers
- 1 pack index cards 3"x5"
- 1 box forks

- 1 box spoons
- 1 container unscented baby wipes
- 1 bottle hand sanitizer
- 2 large boxes of tissues
- 2 large rolls of paper towels

Math

- 1 small white board and eraser
- 4 white board markers (any colors)
- (1) 1½" 3-ring binder
- 1 protractor
- (1) 12" plastic ruler with centimeters and inches

Sixth Grade

- ESV **Study Bible** with concordance, notes and maps (may be purchased through the front desk)
- Backpack
- 3" 3-ring binder white
- 1 pencil pouch that fits into binder
- 48 yellow Ticonderoga #2 pencils, sharpened (one 24-pack collected)
- 2 glue sticks
- 1 box colored pencils or markers
- 4 hardcover composition books
- 1 pair scissors w/ point
- 3 book covers
- 4 plastic 2-pocket folders
- 1 package black pens
- 3 highlighters, 1 of which is yellow
- 2 sheets white poster board
- 4 packages wide ruled notebook paper
- 1 package of 8 binder dividers
- 1 hand held pencil sharpener w/ enclosure
- 1 black sharpie
- 1 pack lined index cards 3x5
- 1 box assorted plastic spoons, forks
- 1 container unscented baby wipes
- 1 bottle hand sanitizer
- 2 large boxes of tissues
- 2 large rolls of paper towels

Math

- 1 plastic folder (3-prong) with pockets
- 1 package graph paper
- (1) 2" 3-ring binder
- 1 package binder dividers
- (1) 12" plastic ruler with centimeters and inches
- 1 small white board and eraser
- 4 white board markers
- 1 Calculator (regular function)

Seventh Grade

- ESV **Study Bible** with concordance, notes and

maps (may be purchased through the front desk)

- backpack
- 1 pencil case that fits into desk
- 12 yellow Ticonderoga #2 pencils, sharpened
- 4 glue sticks
- 1 box colored pencils
- 5 spiral bound notebooks
- 1 pair scissors w/ point
- 1 box colored markers
- 3 large book covers
- 6 plastic pocket folders (3-prong) – 6 diff. colors
- 1 package multi-colored pens
- 1 package blue, black, red pens
- 3 highlighters, 1 of which is yellow
- 2½" – 3" inch 3-ring binder – used as a portfolio for graded work
- 3 sheets white poster board - not foam core (please leave at home until needed)
- 2-3 packages college ruled notebook paper
- 1 package of 8 binder dividers
- 1 hand held pencil sharpener w/ enclosure
- 1 black sharpie
- 1 pack white lined index cards 3x5
- 1 pack colored lined index cards 3x5
- 1 small box assorted plastic spoons, forks
- 1 container unscented baby wipes
- 1 bottle hand sanitizer
- 2 boxes of tissues
- 2 large rolls of paper towels

Math

- 1 clear plastic protractor
- (1) 2" 3-ring binder
- 1 plastic folder (3-prong) with pockets
- 1 Calculator
- (1) 12" plastic ruler with centimeters and inches
- 1 package graph paper
- 1 small white board and eraser
- 4 white board markers

Eighth Grade

- ESV **Study Bible** with concordance, notes and maps (may be purchased through the front desk)
- backpack
- pencil pouch that fits into a binder
- 24 yellow Ticonderoga #2 pencils for the year
- 4 glue sticks
- 4 spiral bound notebooks
- 1 pair scissors w/ point
- (4) 3-prong plastic pocket folders (4 different colors)

- 12 red pens
- Sufficient supply of black or blue pens
- 3 highlighters
- 1 package Expo white board markers (for class)
- 1 package sticky notes
- 2 packages college-ruled notebook paper (for class)
- Student with last name A-M: 1 box of plastic spoons
- Student with last name N-Z: 1 box of plastic forks
- 1 bottle hand sanitizer
- 2 boxes of tissues
- 2 roll of paper towels

Math

- 1 book cover

- 1 small white board and eraser
- 4 skinny white board markers
- (1) 2" 3-ring binder
- 1 package binder dividers
- 1 plastic folder (3-prong) with pockets
- 1 package graph paper
- 1 Calculator (Texas Instruments TI – 30Xa calculator with X^2 , \sqrt{x} and Y^x functions)